

# Smart Portal

## Industrial Series



### Dual-Side, Rugged, RFID Portal System with Middleware

#### **Benefits:**

- *The only portal that includes all RFID hardware and middleware*
- *No recurring licensing fees*
- *No mandatory maintenance fees*
- *Easy to setup and configure*
- *Integrated solution reduces installation costs*

#### **Features:**

- *Durable steel, tubular construction, and backshield*
- *Antenna mounts feature adjustable height, tilt, and skew*
- *Large 12 ft by 10 ft coverage area*
- *TCP/IP Server, HTTP1.1 Client, or RS-232 communications for direct connection to infrastructure*
- *Easy to assemble with 24 ft, low-loss, coax cables*
- *Low voltage and Power-Over-Ethernet enabled*
- *Optional audio/visual indicator and direction-of-travel sensors*



Industrial RFID Smart Portal

## Snapshot

#### **Specifications:**

- *Two general purpose inputs and two outputs*
- *12-24V DC or PoE*
- *Four 9 dBic antennas*

#### **Flexibility:**

- *Optional time stamp with battery back-up*
- *Multiple modes of operation*
- *Software can be customized to your needs*

## Overview

The Element ID portal solution includes the RFID reader, antennas, and mounting stands required for a full-coverage RFID portal. The tubular steel construction is durable enough for deployment in a rugged warehouse environment, yet still suitable for use at doorways in an office environment. The adjustable antenna mounting allows the antenna angles and heights to be configured for use at any doorway or dock door, as well as next to conveyors. The portal ships as easy to assemble stands with reader and antennas already in place to reduce installation time. The product is easy to setup and install and predefined "Personalities" can be used in large deployments to assure that all units are set the same with minimal time and effort. The product is built in the USA and can be customized to specific applications.

# Mechanical Drawing

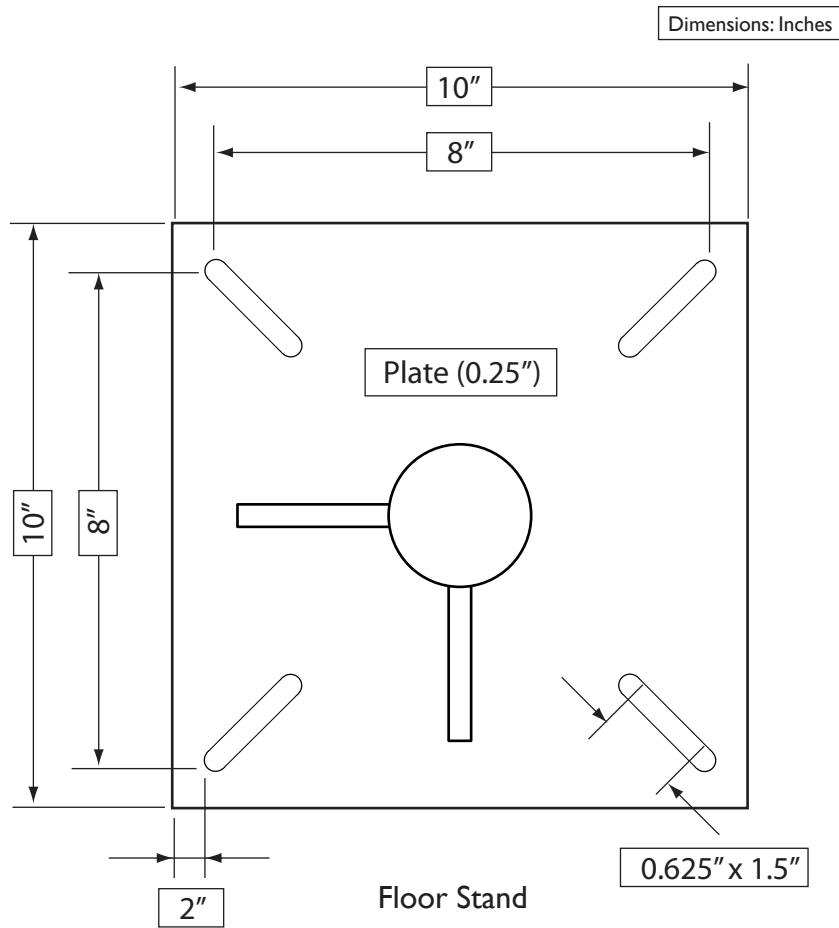
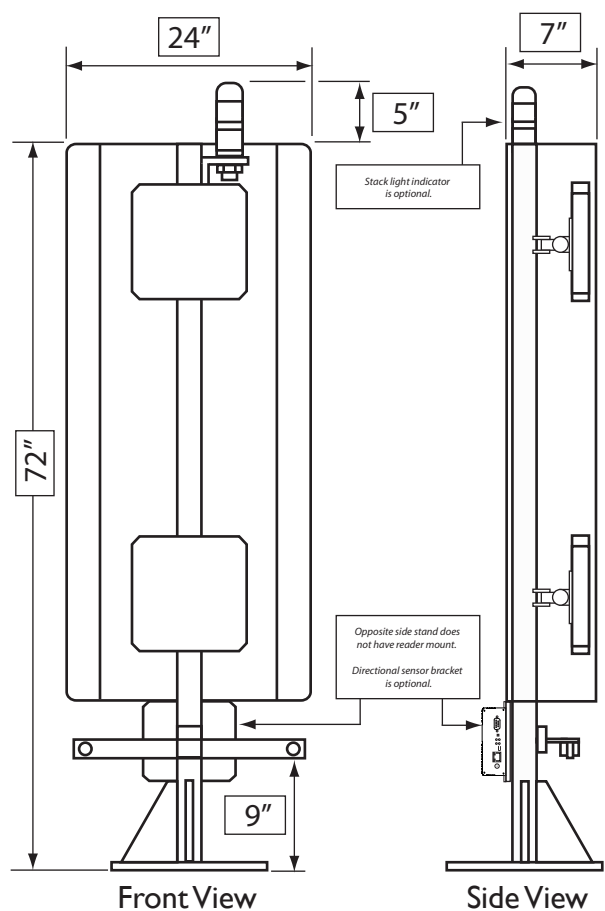

## Specifications

### Electrical

|                     |  |
|---------------------|--|
| RFID Frequency      | 902-928 MHz (UHF - EPC C1G2)   |
| Supported Tags      | EPC Class 1-Gen 2  |
| RF Output           | 1W FCC Part 15 Compliant   |
| Ethernet Comm.      | 10/100 Mbps, Raw TCP/IP Server, HTTP1.1 Web Server Client                          |
| Serial Comm.        | RS-232   |
| General Purpose I/O | Two in, two out (standard)   |
| Power Consumption   | 12 Watts   |
| Power Requirements  | 12 to 24V DC (external power supply)<br>Power over Ethernet IEEE 802.3af           |
| Temp. Rating        | Operating: +32° to +122° F (0° to 50° C)<br>Storage: -4° to 158° F (-20° to 70° C) |
| Relative Humidity   | 10% to 90% non condensing  |

### Mechanical

|            |   |
|------------|---|
| Dimensions | 6 ft (height), 10 in x 10 in (footprint)                              |
| Weight     | 45 lbs (per stand)  |
| Frame      | Powder-coated steel   |
| Separation | 12 ft maximum b/n stands<br>15 ft minimum b/n portals (w/o shielding) |
| Cabling    | 24 ft coax cable extensions for far side                              |

### Other

|                               |   |
|-------------------------------|---|
| Antenna Dimensions            | 10 in x 10 in x 1.5 in                                      |
| Antenna Gain<br>(Quantity: 4) | 9 dBic<br>Circularly polarized                              |
| Serial Connectors             | 9-Pin D-Subminiature (Female)<br>Micro-USB, Type-B (Female) |
| Power Connector               | 2.1 mm Barrel Connector                                     |